



# Cemeteries 50-Year Masterplan 2023



Natural | Connected | Prosperous

## Acknowledgement of Country

“Kaya, Nala Maat Kaya Noonduk (Hello, Our Family Welcomes You) to Wadandi Boodja (Saltwater People’s Country) – we all come together on Boodja (Country). Whilst on Wadandi Boodja we ask that you respect the land by walking softly and take the time to listen to Boodja as she Wongi (Talks).

We respect the presence of the Demmala Goomala (Ancestors) whose Djanga (Spirits) reside on Boodja and whose Djenna (feet) walk the land and whose Djanga Korda (heart spirit) flows through all creation. Wooditjup (Margaret River) is the heart of Wadandi Boodja (country), a meetingplace between land and sea, connecting us all with Wadandi Boodja.

The Wadandi Boodja (Motherland) reaches from Bunbury, along the coast of Geographe Bay, extending to Yallingup (Place of Holes) to Taalinup, Augusta (Place of Reeds) inland to Nannup (The Stopping Place), taking in the region of Undalup (Busselton). The Wadan Boodja (Sea Country) is of great spiritual significance to the coastal Wadandi people.

Boodja – Land, Country, Mother Earth – is our most important resource. No matter what culture or religion – all of us rely on Nala Boodja, Our Country.

It is up to all of us to listen to the land, understand the connection to Country that we all have and realise how urgent it is to work together to make better decisions on how we can create that balance, ensuring sustainability for the generations to come, in order to protect and preserve the beauty of Boodja.

Whilst living, travelling, visiting and holidaying on Wadandi Boodja (Saltwater People’s Country) we ask that you respect the area and walk softly on the country, taking the time to listen to Boodja (Country) as she Wongi (Talks) of the Season, and leave nothing but footprints”.

**Wadandi Traditional Cultural Custodian  
Wayne “Wonitji” Webb.**

Image (right): A natural land art piece by Wadandi Matriarch Vivian Brockman, Mitchella Hutchins, artist Elaine Clocherty and community members, centred around djanga coombart ‘family spirit’.







# Community Vision

▶ **Augusta Margaret River Sustainable, inclusive, connected to place and respecting Boodja**

## Alignment to the Strategic Community Plan 2040

### ENVIRONMENT

We will protect and enhance the unique natural environment and biodiversity of the region through climate action and informed decision making.

#### We will focus on:

- **Outcome EN.1:** Ecology and biodiversity protection
- **Outcome EN.2:** Healthy waterways, foreshores and natural landscapes
- **Outcome EN.3:** Collective climate action
- **Outcome EN.4:** Sustainable resource and waste management

### PEOPLE

We will support and strengthen our diverse, resilient, welcoming, safe and connected community through our services and advocacy.

#### We will focus on:

- **Outcome PE.1:** Diverse cultural values are respected and adopted
- **Outcome PE.2:** Equal opportunities for all
- **Outcome PE.3:** Active, healthy and fulfilling lifestyles
- **Outcome PE.4:** Safe and resilient communities

### PLACE

We will responsibly develop vibrant, sustainable places which maintain their distinctive characters, and which supports a local economy that is resilient, equitable and sustainable.

#### We will focus on:

- **Outcome PL.1:** Diverse, sustainable and well-designed places
- **Outcome PL.2:** Infrastructure which caters to need
- **Outcome PL.3:** Sustainable agriculture and thriving rural community
- **Outcome PL.4:** Resilient circular local economy

### PERFORMANCE

We will deliver quality governance, service and value with integrity and transparency.

#### We will focus on:

- **Outcome PF.1:** Responsible planning and ownership of outcomes
- **Outcome PF.2:** Community and customer focus
- **Outcome PF.3:** High performing and engaged people
- **Outcome PF.4:** A culture of innovation, quality and continuous improvement



# Contents

<b>Introduction</b>	<b>5</b>
<b>Part 1 – What we have</b>	<b>7</b>
1.1 Margaret River Cemetery - Existing Conditions	7
1.2 Karridale Cemetery - Existing Conditions	9
1.3 Cemetery Capacity	13
<b>Part 2 – Consultation and research</b>	<b>17</b>
2.1 Community Engagement	17
2.2 Comparative Analysis with Other Local Governments and Cemetery Boards	18
2.3 Consideration of Fees and Charges	19
<b>Part 3 – Principles and actions</b>	<b>21</b>
3.1 Guiding Principles and Recommendations	21
3.2 Proposed Projects	24
3.3 Action Plan	37
<b>Summary</b>	<b>26</b>
<b>Appendices</b>	<b>41</b>



# Introduction

## Executive Summary

The Cemeteries 50-Year Masterplan is an action plan that provides the Shire of Augusta Margaret River and its community members with a clear understanding of where priorities, resources and energies are to be directed in relation to the future development and management of the Margaret River and Karridale Cemeteries over the next 50 years.

## Guiding Principles

The key principles that underpin the development of the Masterplan have been drawn from contextual research including community and stakeholder consultation:

1. Increase the Lifespan of Cemeteries
2. Conserve Heritage Values
3. Improve Access within Cemeteries
4. Enhance Cemetery Experience

## Vision

The Shire's cemeteries hold significant value to individuals and families throughout their lifetimes. They are the final resting place for loved ones. The Shire's vision is to create peaceful places to memorialise, honour and reflect on those who have died and allow inter-generational connection to our community's history and genealogy.

The Masterplan is the Shire's commitment to the community to provide choice as to where they can be laid to rest, peaceful places for visitors to gather and commemorate loved ones and allow ongoing connections between people and place.

## Objectives

This 2023 Masterplan will:

- Provide the Shire with direction for the continued operation of the cemeteries, by way of informing the Asset Management Plan and Long Term Financial Plan.
- Be used to communicate the Shire's vision for the cemeteries, setting goals and maintaining goals through the years.

The Masterplan consists of major and minor development projects and options for cemetery expansion to meet burial demand over the next 50 years. Implementation of all projects are specified in the Action Plan which sets out timeframes and teams responsible for the delivery of each individual project.

All future proposed development projects and expansion options within the cemeteries are to be examined against the Strategic Community Plan 2040 to ensure suitability.

## Key Masterplan Recommendations

- Investigate alternative options to accommodate future burial demand
- Investigate feasibility of capital works on a project-by-project basis
- Investigate feasibility of operational works on a project-by-project basis
- Investigate options for a community volunteer group



## History / Background

- The Karridale Cemetery was established in 1898, with the earliest marked gravesites dated from 1901.
- Margaret River Cemetery was established in 1921.
- Both cemeteries are places of historical significance for the local community, positively contributing to the heritage of the Shire.
- Many people involved in the settlement and development of the region from the late nineteenth century are buried in the cemeteries.
- Under the *Cemeteries Act 1986*, the Shire is the Augusta Margaret River Cemetery Board, responsible for the operation of the Margaret River and Karridale Cemeteries.
- As of today, sections of the Margaret River Cemetery are nearing burial plot capacity.
- As part of the creation of this Masterplan, field audits, land surveys, data collection and analysis has occurred to inform and produce a 50-year plan.

## Document Lifespan

This Masterplan is a 'living document' which will be reviewed and updated every two years as it responds to local demographics, burial demand and changes in community needs.

## Strategic and Legal Considerations

This Masterplan has been drafted within the parameters of the Shire's:

- Strategic Community Plan 2040
- Corporate Business Plan

And will be used to inform the:

- Asset Management Plan
- Capital Works Plan
- Long Term Financial Plan

The Strategic Community Plan 2040 sets the vision, focus areas and strategies for the next 20 years. This community vision feeds into the Masterplan by mapping out where the cemeteries need to be and how we will get there. In turn, the Cemeteries 50-Year Masterplan will inform the next strategic community plan.

The Shire is required to comply with the following legislation related to cemetery management:

- *Cemeteries Act 1996*
- Shire of Augusta Margaret River Cemetery Local Law

## Methodology

The Masterplan has been assembled using the following methodology:

- **Research and analysis**  
Analysis of existing cemetery conditions, local demographic and burial trends.
- **Stakeholder engagement**  
Engaging with key stakeholders, including local communities, organisations and government agencies, to understand their needs, goals and concerns.
- **Visions and goals**  
Developing guiding principles and a vision based on research analysis and stakeholder engagement.
- **Actions and recommendations**  
Developing a range of recommendations that respond to the vision and goals.
- **Implementation planning**  
A plan for implementing the Masterplan including phasing, resources and funding sources.



# Part 1 – What We Have

## 1.1 Margaret River Cemetery - Existing Conditions

The Margaret River Cemetery is located on Reserve 12298 on the south side of Wallcliffe Road and west of Caves Road. It covers a total area of approximately 46,300 square metres and is located on the major travel route between the Margaret River town site (7km to the east) and the beachside suburbs of Prevelly and Gnarabup (3km to the west) along Wallcliffe Road. The cemetery has been slowly developed over a long period of time allowing an informal layout to occur with large native trees retained throughout. Combined with gravel roads and pathways, minimal signage and simple walls and feature elements, the overall aesthetic of the cemetery provides a local and rural feel.

In 2018 a draft landscape concept plan was produced for the Margaret River Cemetery (Appendix 2). Some elements of this draft concept were actioned in 2019 including construction of a shelter, creation of internal pathways and landscaping. Some other elements have been incorporated into proposed projects for this Masterplan, including vegetation screening along the northern boundary, creation of memorial gardens, a new historical entrance map, signage for denominational areas and creation internal walkways, which are further detailed in Part 3.2 'Proposed Projects'. All remaining proposals from the 2018 landscape concept plan have been considered redundant.

*Existing Margaret River Cemetery*





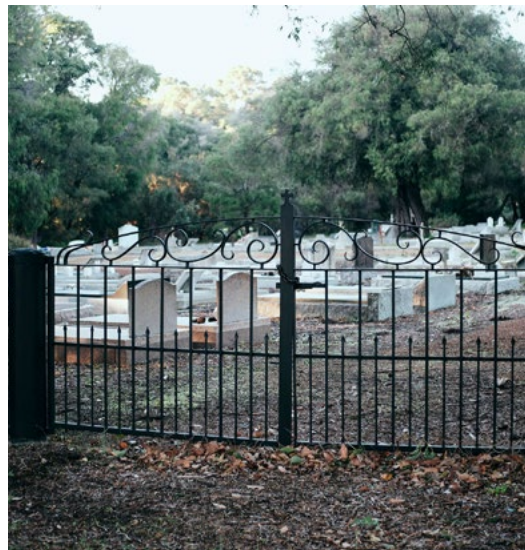
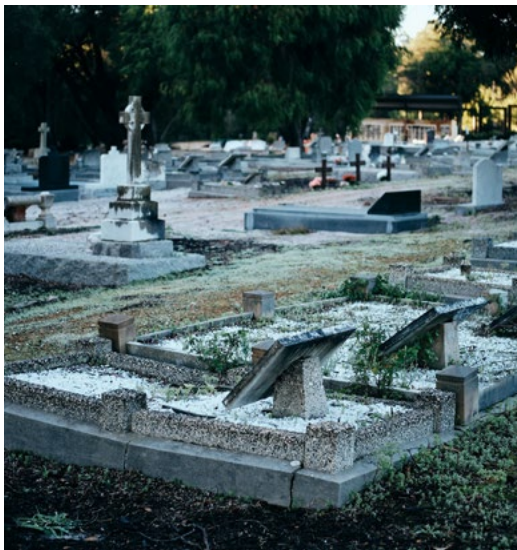

*Shelter, pathway, bench seating and landscaped area constructed in 2019 as per 2018 Draft Concept Plan (Appendix 2)*



## 1.2 Karridale Cemetery - Existing Conditions

The Karridale Cemetery is located on Caves Road. It offers an open undulating natural rural setting, informally scattered with peppermint and pine trees. Like Margaret River, the Karridale Cemetery has been slowly developed over a long period of time

and as such is laid out over a large area with developed denominational sections. There are steel gates at the entrance and one gravel pathway that runs through the middle of the cemetery. Adjacent to the entry are two niche walls and a shelter.

*Existing Karridale Cemetery*







Images supplied by Karridale Cemetery



## 1.2.1 Natural Burial

In consultation with special interest group Death and Dying Matters, in 2021 the Shire established a designated area of the Karridale Cemetery for natural burials.

In a departure from the granite monuments of the conventional cemetery, natural burials offer the community a unique and sustainable final resting place with minimal disturbance to the natural bushland environment.

Natural burials at Karridale Cemetery are located within the southeast corner of the cemetery, left of the entrance, this unique pocket of bushland will be progressively vegetated with natural plant species as plots are utilised.

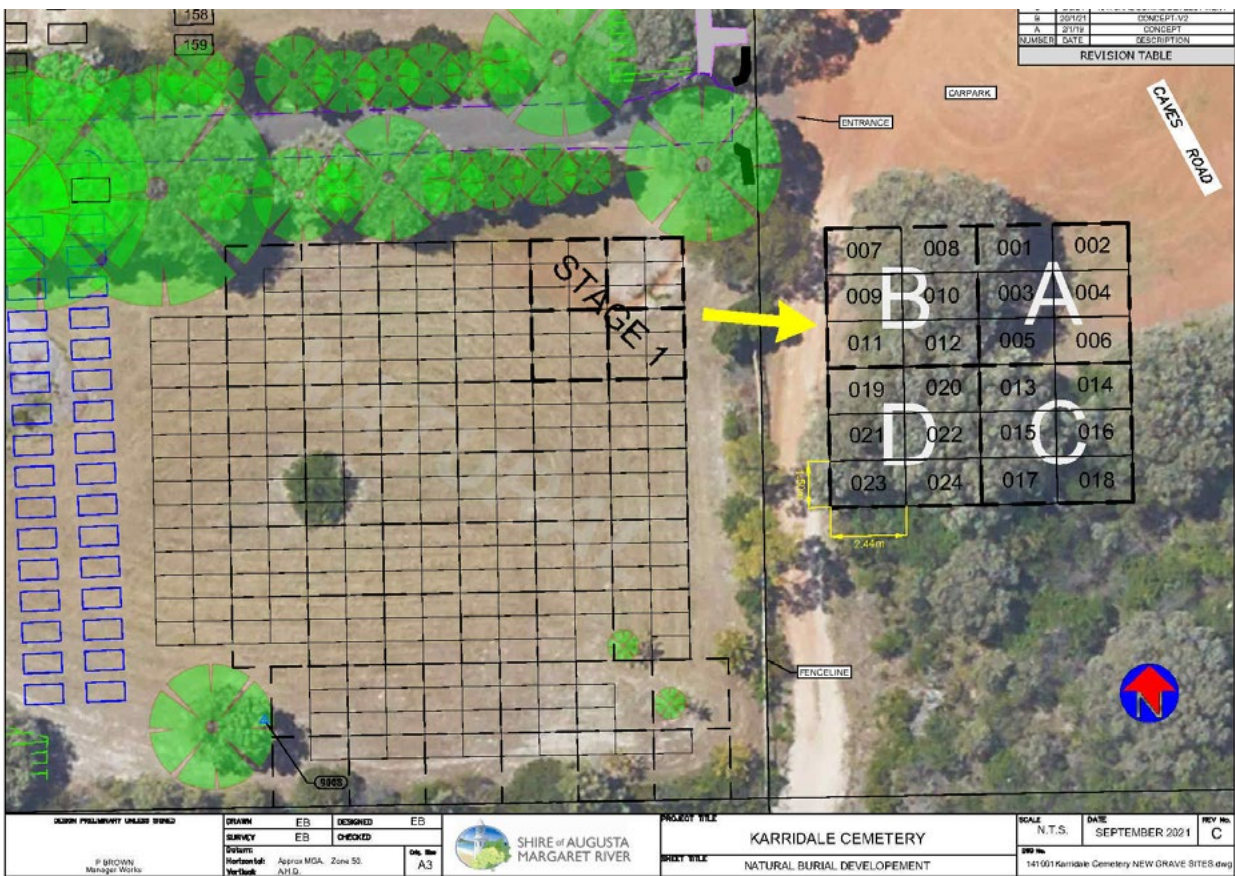

Natural burial survey plan





*Natural burial area*



## 1.3 Cemetery Capacity

Running out of burial space is not an issue unique to the Shire, many traditional cemeteries within Australia, and globally, are nearing capacity causing cemetery boards and individuals to rethink about the resources and options that are devoted towards final disposition.

The Shire itself has seen an increase in demand for simple and sustainable burial options, and as a result has created a natural burial area within the Karridale Cemetery.

Over the last ten years, there has been a decline in traditional burials in the Margaret River and Karridale cemeteries, despite population growth within the Shire.

As of July 2022, the Margaret River Cemetery had approximately 276 vacant non-denominational plots for traditional burial within existing cleared areas. Karridale Cemetery had approximately 282 vacant plots for traditional burial across denominational and non-denominational cleared areas combined and 189 vacant natural burial plots.

The lifespan of the Shire's cemeteries within cleared areas has been forecast using population growth rates, death rates (ABS 2016 census) and burial trends (within the Shire), analysed to predict the number of plots required within the Margaret River and Karridale cemeteries over the next 50 years.

Shire Population

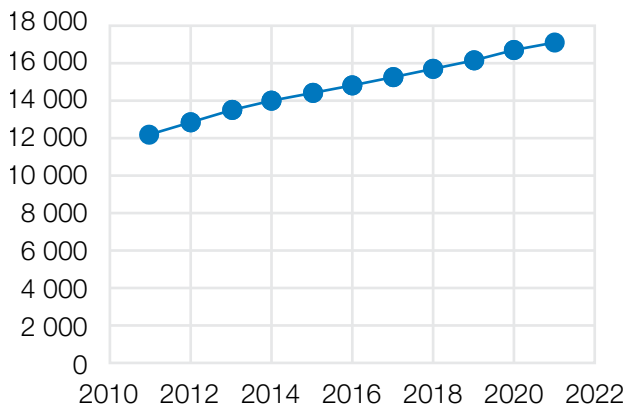

\* data source, ABS 2016 census  
Augusta Margaret River

% of deceased that are buried Trendline

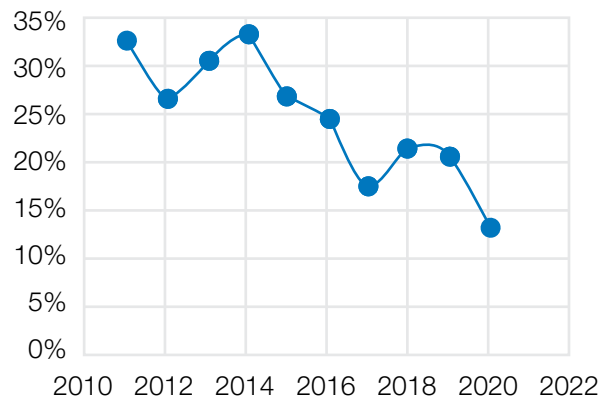

\* data source, ABS 2016 census  
Augusta Margaret River





Remaining cleared area within Margaret River Cemetery



Based on the below average trendlines, the number of plots required have been forecast and are shown in the table below:

- 0.48% death rate of the Shire’s population
- 30% of deceased that are buried\*
- Of deceased buried, 67.7% being buried in Margaret River and 32.3% being buried in Karridale

Year	Forecast Population within Shire	Forecast annual no. deaths within Shire	Forecast annual no. of burials in Margaret River	Forecast annual no. of burials in Karridale per year	Forecast total burials	Forecast total cumulative burials	Cumulative burials forecast for Margaret River	Cumulative burials forecast for Karridale
2025	19607	96	10	5	15	57	41	16
2030	23213	114	12	5	17	140	100	40
2035	27482	135	14	6	20	237	168	69
2040	32536	160	16	8	24	351	248	103
2045	38518	189	19	9	28	486	341	145
2050	45600	224	23	11	34	646	452	194
2055	53984	265	27	13	40	834	582	252
2060	63909	313	32	15	47	1,056	735	321
2065	75658	371	38	18	56	1,319	915	404
2070	89565	439	45	21	66	1,629	1127	502

*\*The percentage of deceased that are buried has been conservatively estimated at 30% despite the trendline last being recorded at 13%. This strategy aims to account for potential risks and uncertainties.*



It is predicted that **Margaret River** will have reached capacity within already cleared areas by **2034**. Estimating that the **Margaret River Cemetery has a lifespan of 11 years**.

It is predicted that **Karridale** will have reached capacity within already cleared traditional areas by **2044**. Estimating that the **Karridale Cemetery has a lifespan of 21 years**.

### Religious / Denominational Sections

Both cemeteries have in the past offered plots within areas designated for religious denominations, however as the Margaret River Cemetery nears capacity, other than for plots already reserved, there is not capacity for burial within the Roman Catholic, Congregational or Anglican sections. All new burials are now within the non-denominational section.

Introduction of only non-denominational areas will allow the cemeteries to be more compact, utilise space better and ensure the layout follows the natural contours of the land.

As a result, it is recommended that all new burial areas in the Margaret River and Karridale cemeteries will be non-denominational and available for use by all. The Shire will not offer specific or restricted areas for religious groups.

### Natural Burial

Natural burial space is limited. As natural burial is new, there are no available statistics, however as at April 2023, there were 189 vacant plots.



# Part 2 – Consultation and Research

## 2.1 Community Engagement

The Shire conducted a six-week community engagement and stakeholder consultation program. The objective to acquire feedback in relation to current services, standards and infrastructure to help identify short-term, medium-term and long-term priorities for how the Margaret River and Karridale cemeteries will be developed and maintained to meet future burial demand and community needs.

### Key Findings

Participants commented on what they loved about the cemeteries and ranked areas which they considered in need of improvement. The following were flagged as areas of high importance to the community:

- **Appearance**

Participants loved the natural bush feel of the Karridale Cemetery but felt Margaret River needed some care and attention to make it more visually appealing. Participants flagged that the overall appearance of both cemeteries could be improved with more frequent general tidy-ups of debris and waste.

- **Facilities for Funerals and Visitors**

Participants ranked facilities as a priority area for improvement, including provision of shelter, seating and toilets.





## 2.2 Comparative Analysis with Other Local Governments and Cemetery Boards

For the purpose of conducting a comparative review of services offered and operational processes followed, including a look at natural burials, memorial options and fees and charges, the Shire visited the following five Western Australian Cemeteries:

- Bunbury Cemetery and Memorial Gardens (Bunbury Cemetery Board)
- Pinjarra Cemetery (Shire of Murray)
- Old Mandurah Cemetery (closed) (City of Mandurah)
- Lakes Lawn Cemetery (City of Mandurah)
- Fremantle Cemetery (Metropolitan Cemeteries Board)

### Key Findings

All of the above cemeteries provide a range of choices for memorials with or without the placement of ashes; memorial gardens; memorial walls; memorial benches; memorial trees; memorial plaques. The Shire does not currently offer this service.

In Australia, the percentage of cremation against other forms of disposition of deceased persons was 65.19% (National Cremation Capacity Survey 2020, Australasian Cemeteries and Crematoria Association). With a nationwide increase in cremations and decline in burials, demand for other options (with or without placement of ashes) has increased. Memorial packages have the potential to generate a stream of revenue for the Boards with little ongoing maintenance cost.

Outcomes of the community and stakeholder engagement program and research findings were analysed and used to develop a series of guiding principles which informed a set of recommendations.





## 2.3 Consideration of Fees and Charges

The cemeteries combined generate approximately \$63,000 in revenue per year and have total expenditures of approximately \$52,000 per year.

Income is generated through the Shire's fees and charges, and expenditures are generally linked to administration of the burial process and maintenance and upkeep of the cemetery grounds.

There is potential to increase revenue by provision of additional services and review of current operational services, for example, but not limited to;

- Provision of alternative memorial options with or without interment of ashes
- Transition away from external contractor to 'in-house' digging of graves

An increase in revenue would in turn allow for the Shire to provide additional operational services, for example increased maintenance/cleaning of the cemeteries, which was considered a priority amongst stakeholders.

It is recommended that a cemetery business plan be developed, taking into account the day-to-day operations of the cemeteries, including staffing, facilities management and equipment, to provide financial projections including revenue, expenses and profitability.







# Part 3 – Principles and Actions

## 3.1 Guiding Principles and Recommendations

The development of four guiding principles was determined by a combination of community and stakeholder consultation and research outcomes.

### 1. Increase the Lifespan of Cemeteries

Action:

Progressively expand cleared areas to accommodate future burial demand.

### 2. Conserve Heritage Values

The cemeteries are culturally significant to many visitors as a source of history and genealogy.

Actions:

Promote historic significance and improve interpretive elements of the cemeteries.

Create digital access to cemetery records.

### 3. Improve Access within Cemeteries

Assist visitors find their way around the cemetery.

Actions:

Path networks,  
Wayfinding signage.

### 4. Enhance Cemetery Experience

Enhancing the amenity with areas for seating, pausing and reflection.

Actions:

Seating, shelter and toilets.  
Review maintenance service levels.

The above key guiding principles are a set of values that have guided the process of prioritising projects and recommendations within the Masterplan. They provide the foundation to make consistent and ethical choices, even in the face of uncertainty or difficult circumstances. The principles provide clarity, consistency, accountability, alignment, and adaptability. By following these principles, the Shire can make better decisions, build trust, and achieve Masterplan goals while staying true to values.



In line with the key guiding principles, a series of actions have been recommended:

### 3.1.1 Increase Cemetery Lifespan

#### Informed by

Analysis of existing conditions, demographics and burial trends.

#### Outcome

The cemeteries will eventually reach burial capacity (Margaret River by approximately 2034 and Karridale by approximately 2044). This principle relates to planning for expansion of cleared areas or considering alternative options to accommodate future burial demand.

#### Actions

- Consider options for expansion
- Consider options for acquisition of new lands
- Consider alternative interment options
- Consider closing cemeteries

### 3.1.2 Conserving Heritage Values

#### Informed by

Stakeholder and community consultation.

#### Outcome

The cemeteries are significant to many visitors as a source of genealogy and the resting place of many prominent individuals in history.

#### Actions

- Promote historic significance and improve interpretive elements of the cemeteries.
- Create digital access to cemetery records.

### 3.1.3 Improving Access

#### Informed by

Stakeholder and community consultation and analysis of existing conditions.

#### Outcome

This principle focuses on assisting visitors to find their way around and through the cemeteries. Pedestrian movement should be simple, convenient and a positive experience for all visitors.

#### Actions

- Walkway networks within cemeteries
- Wayfinding signage

### 3.1.4 Enhancing the Cemetery Experience

#### Informed by

Comparative analysis with other local governments and cemetery boards. Stakeholder and community consultation.

#### Outcome

The cemeteries are visited foremost by people coming to attend funerals or visit loved ones. Other visitors also visit the sites to see, understand and research heritage and historical elements and also enjoy the peaceful experience. As part of this Masterplan, the following actions are proposed for enhancing amenity with areas for seating, pausing and reflection.

#### Actions

- Install seating, shelter and toilets
- Review maintenance service levels

These actions have been broken down and summarised as a series of individual projects. These proposed projects are listed below, with a detailed action plan on page 24.









## 3.2 Proposed Projects

The implementation of each project will need to be considered on an annual basis and align with the Shire's Annual Budget, Long Term Financial Plan and Asset Management Plan.

Each project has been given a simple ranking of high, medium and low priority and is driven by demand from the community.

### Priority Ratings:

#### **H** High priority (to be carried out in the first 1-5 years)

Projects that were flagged areas of high importance to stakeholders and which are likely to have significant and immediate positive impact in the cemetery and its operations.

#### **M** Medium priority (5 – 10 years):

Projects which involve further investigation/negotiation.

#### **L** Low priority (10 years +):

Projects which require further investigation and significant budget allowance.



## Principle 1: Increase lifespan of the cemeteries

### 1.1 MR:

## Options for Expansion: Margaret River Cemetery

**Priority:** High **H**

**Concept:** Expand cleared area to accommodate future burial demand

**Site Constraints and Opportunity:**

Opportunity	Constraint/s
a) Non-continuation of denominational areas	<ul style="list-style-type: none"> <li>• Nil</li> </ul>
b) Expansion of cleared area to the south	<ul style="list-style-type: none"> <li>• Land currently used by the Margaret River Golf Club</li> <li>• Clearing permit required</li> </ul>
c) Expansion of cleared area to the west	<ul style="list-style-type: none"> <li>• Clearing permit required</li> <li>• Wallcliffe fire shed and carpark</li> </ul>
d) Expansion of cleared area to the east	<ul style="list-style-type: none"> <li>• Clearing permit required</li> <li>• Water</li> </ul>
e) Consider vertical burials	<ul style="list-style-type: none"> <li>• Deeper holes required</li> <li>• New machinery required</li> </ul>
f) Expansion for memorial gardens to the west	<ul style="list-style-type: none"> <li>• Trees to remain</li> <li>• Clearing permit for low-laying vegetation may be required</li> </ul>
g) Acquisition of new lands	<ul style="list-style-type: none"> <li>• Budget</li> <li>• Environment</li> <li>• Zoning and land use regulations</li> <li>• Physical characteristics</li> </ul>
h) Restrict Grant of Right of Burial (to those living within the Shire)	<ul style="list-style-type: none"> <li>• Exclusion of non-locals could be perceived as discriminatory</li> <li>• Does not promote diversity and inclusivity</li> </ul>
i) Closure and non-continuation of cemetery	<ul style="list-style-type: none"> <li>• Impact on local community</li> </ul>
j) Explore options for memorials (without interment of ashes) outside of the cemetery	<ul style="list-style-type: none"> <li>• Excludes burial</li> <li>• Excludes interment of ashes</li> </ul>





Aerial photo of Margaret River Cemetery



Aerial photo of Margaret River Cemetery showing cleared area available.



Aerial photo of the Margaret River Cemetery south boundary.

**Objectives:**

- Increase cemetery lifespan

**Summary of works:**

- Scope the site to determine possible alignments
- Consult relevant stakeholders to determine clearing permit implications

**Recommendation:**

The preferred option for expansion is to the south boundary (option b), this opportunity for expansion has the least constraints.

To commence with investigation of option (b): expansion to the south.



## Principle 1: Increase lifespan of the cemeteries

### 1.1 K:

## Options for Expansion: Karridale Cemetery

**Priority:** Medium **M**

**Concept:** Expand cleared area to accommodate future burial demand

### Site Constraints and Opportunity:

Opportunity	Constraint/s
a) Non-continuation of denominational areas	<ul style="list-style-type: none"><li>• Nil</li></ul>
b) Consider vertical burials	<ul style="list-style-type: none"><li>• Deeper holes required</li><li>• New machinery required</li></ul>
c) Expansion for memorial	<ul style="list-style-type: none"><li>• Trees to remain</li><li>• Clearing permit for low-laying vegetation may be required</li></ul>
d) Acquisition of new lands	<ul style="list-style-type: none"><li>• Budget</li><li>• Environment</li><li>• Zoning and land use regulations</li><li>• Physical characteristics</li></ul>
e) Restrict Grant of Right of Burial (to those living within the Shire)	<ul style="list-style-type: none"><li>• Exclusion of non-locals could be perceived as discriminatory</li><li>• Does not promote diversity and inclusivity</li></ul>
f) Closure and non-continuation of cemetery	<ul style="list-style-type: none"><li>• Impact on local community</li></ul>

### Objectives:

- Increase cemetery lifespan

### Summary of works:

- Scope the site to determine possible alignments
- Consult relevant stakeholders to determine clearing permit implications

### Recommendation:

To investigate and determine a preferred option for increasing the cemetery lifespan.





Aerial photo of Karridale Cemetery



## Principle 1: Increase lifespan of the cemeteries

### 1.2: Memorial Gardens: Margaret River

**Principle 1:** Increase lifespan of the cemeteries

**Priority:** High 

**Concept:** Memorial garden for interment with or without ashes

#### Summary of Works:

- Link cemetery to firewise garden by removing fence and extending pathways
- Clear low-laying vegetation (clearing permit required)
- Establish path route through existing vegetated area

#### Objectives:

- Increase aesthetic appeal
- Create new memorial options
- Increase revenue and asset

#### Recommendation:

To commence with investigation of the suitability of establishing a memorial garden in the Margaret River Cemetery and additional alternate locations for memorial gardens (for interment with or without ashes)

*\*Subject to completion of a business plan (shown at 4.1 - MR/K)*

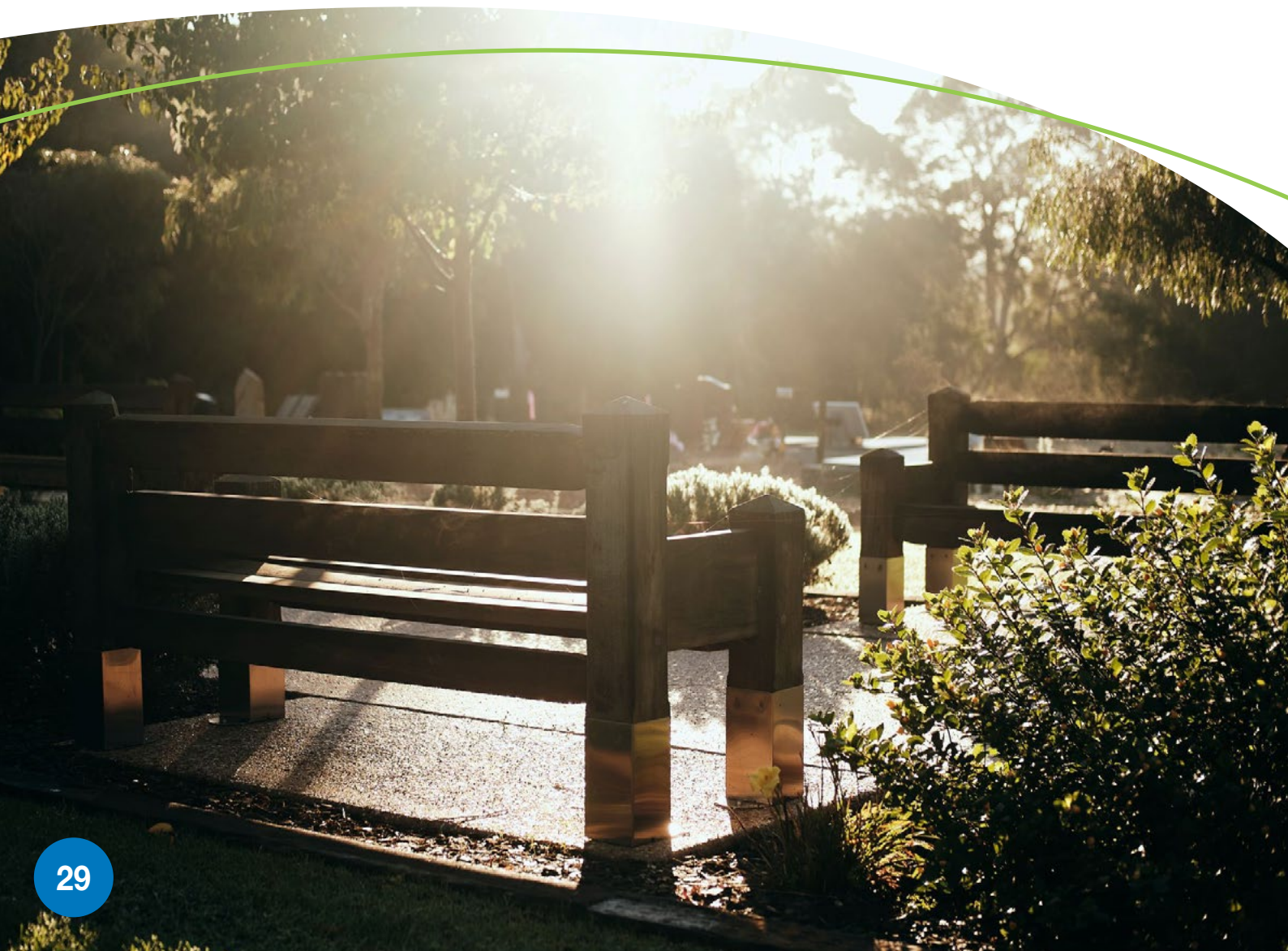



## Principle 2: Conserving heritage values

### 2.1 MR/K:

## Establish a 'Friends of' Cemetery Volunteer Group

**Priority:** High **H**

**Concept:** Establish and lead a 'friends of' cemetery volunteer group

**Summary of Works:**

- Clarify purpose and goals / develop guidelines and procedures
- Promotion / stakeholder engagement
- Recruitment of volunteers
- Provision of training, equipment

**Objectives:**

- Bring the community together with a shared interest
- Raise awareness by promoting the conservation and appreciation of the Margaret River and Karridale Cemeteries
- Assist with beautification, historic preservation and conservation of cemeteries
- Bridge the gap between current funding levels and service expectations

**Recommendation:**

To establish a 'friends of' cemetery volunteer group.

## Principle 2: Conserving heritage values

### 2.2 MR/K:

## Launch an Interactive Geographic Information System with Search Functionality on the Shire Website

**Priority:** Medium **M**

**Concept:** Develop and launch a live, interactive and accurate cemetery geographic information system (GIS) on Shire website with search functionality. Data will show where someone is buried, plot location, date of birth, date of death and a photo of the plot site.

**Summary of Works:**

- Collation and export of GIS data
- Inclusion in Shire website improvements program

**Objectives:**

- Promote historical significance and interpretive elements by way of digital access
- Allow search functions for genealogy and historic purposes
- Encourage a sense of connection to place

**Recommendation:**

To commence with development and launch of a live, interactive, accurate cemetery geographic information system with search functionality.



## Principle 3: Improve access within cemetery

### 3.1 MR/K: Historical Entrance Map

**Priority:** Medium **M**

**Concept:** Installation of wayfinding entrance map which includes a QR code that links to the Shire website (linked to 2.2 above).

**Summary of Works:**

- Design of entrance map
- Construction of entrance map
- Installation of entrance map

**Objectives:**

- Assist visitors to navigate around the cemeteries, access information on demand and find loved ones / sites
- Assist visitors identify the different areas within the cemeteries
- Assist visitors and give access to the history and genealogy
- Enhance visitor experience

**Recommendation:**

To commence with the design, installation and maintenance of wayfinding entrance map including a QR code which links to the Shire's website.

*Existing Karridale entrance signage to be retained*





MARGARET RIVER



Cemetery



ENTRANCE & CARPARK

*Existing Margaret River entrance  
signage to be retained*



## Principle 3: Improve access within cemetery

### 3.2 MR/K:

## Installation of Internal Signage for Denominational Areas

**Priority:** High **H**

**Concept:** Installation of internal signage

**Summary of Works:**

- Design of internal signage
- Construction of internal signage
- Installation of internal signage

**Objectives:**

- Assist visitors to navigate around the cemeteries and find loved ones / sites
- Assist visitors to help identify the different areas within the cemeteries

**Recommendation:**

To design and install internal wayfinding signage.





## Principle 3: Improve access within cemetery

### 3.3 MR/K: Walkways

**Priority:** High **H**

**Concept:** Installation of internal walkways

**Summary of Works:**

- Create walkways within and around burial areas

**Objectives:**

- Define walkway and improve link between burial sections
- Lead visitors through gravesites

**Recommendation:**

To commence with investigation of the feasibility of installing internal walkways in line with the style guidelines (Appendix 1)

## Principle 4: Enhance cemetery experience

### 4.1 MR/K: Develop Cemetery Business Plan

**Priority:** High **H**

**Concept:** Develop a business plan for the operation of both cemeteries

**Summary of Works:**

- Review current operational practices
- Review current fees and charges
- Review cost-effectiveness of transitioning to 'in-house' gravedigging

**Objectives:**

- To outline the strategy, operations and financial projections, including revenue, expenses and profitability for the cemeteries

**Recommendation:**

To develop a business plan for effective operational management of the cemeteries.



## Principle 4: Enhance cemetery experience

### 4.2 K: Installation of Seating

**Priority:** High **H**

**Concept:** Seating for visitors

**Summary of Works:**

- Installation of benches

**Objectives:**

- To provide visitors places to rest and reflect

**Recommendation:**

To install bench seats.

## Principle 4: Enhance cemetery experience

### 4.3 MR/K: Installation of Toilet

**Priority:** High **H**

**Concept:** Installation of an accessible, eco-friendly (composting) universal toilet

**Summary of Works:**

- Installation of an accessible, eco-friendly (composting) universal toilet

**Objectives:** Convenience for visitors and families

**Short Term Options:** Portable toilet

**Recommendation:** To install portable toilets at each cemetery.

To investigate the feasibility of installation and maintenance of an accessible, eco-friendly, universal toilet in the Margaret River and Karridale cemeteries.

## Principle 4: Enhance cemetery experience

### 4.4 M: Vegetation Screening along Northern Perimeter Boundary

**Priority:** Medium **M**

**Concept:** Vegetation screen between Margaret River Cemetery boundary and Wallcliffe Road

**Summary of Works:**

- Planting of suitable vegetation
- Planting of WA peppermint trees

**Objectives:**

- More aesthetically pleasing

**Recommendation:**

To plant and maintain vegetative screening along the northern perimeter boundary of the Margaret River Cemetery.



## Principle 4: Enhance cemetery experience

### 4.4 K: Construction of Shelter - Karridale

**Priority:** Medium **M**

**Concept:** Gazebo area

**Summary of Works:**

- Installation of shelter in Karridale

**Objectives:**

- Create a sheltered area for funeral services held at the Karridale Cemetery

**Recommendation:** To commence with design and concept (Appendix 3) for a shelter in the Karridale cemetery.



*Conceptual view of shelter at Karridale – full concept at Appendix 3*

## Principle 4: Enhance cemetery experience

### 4.5 K: Operational Maintenance

**Priority:** High **H**

**Concept:** To address outstanding operational maintenance issues

**Summary of Works:**

- Removal of dis-used water tank
- High-pressure clean existing pavers
- Re-paint entry gates
- High-pressure clean niche walls

**Objectives:**

- Cemetery beautification

**Recommendation:**

To commence with the above summary of works to address outstanding operational maintenance issues in line with the Karridale concept as shown in Appendix 3.



### 3.3 Action Plan

The goals, principles and objectives of the Masterplan can be achieved through implementing the above projects. The below tables list proposed individual projects for the Margaret River (table 1) and Karridale (table 2) cemeteries.

Each project considers:

- **Responsibility** – the service area that will lead and support the implementation of the specific project
- **Funding** – the allocation of resources from within existing, capital or new budget items
- **Timeline** – when the project will be implemented





**Table 1 – Individual Projects – Margaret River**

No	Project	Service Area	Funding resource	2023-24	2024-25	2025-26	2026-27	2027+
<b>Principle 1: Increase lifespan of the Cemeteries</b>								
1.1 - MR	Investigate options for increasing lifespan	Legal / Governance Landcare / Environment	OPEX*		✓			
1.2 - MR	Create memorial gardens in Margaret River	Asset Services, Works	OPEX			✓		
<b>Principle 2: Conserving Heritage Values</b>								
2.1 - MR	Establish a 'friends of' group	Landcare / Environment	OPEX*	✓				
2.2 - MR	Launch an interactive geographic information system with search functionality on the Shire website	ICT, Asset Services	OPEX				✓	
<b>Principle 3: Improve Access within Cemetery</b>								
3.1 - MR	New historical entrance map	Asset Services, Works	CAPEX				✓	
3.2 - MR	Installation of signage for denominational areas	Asset Services, Works	CAPEX*		✓			
3.3 - MR	Install internal walkways	Parks and Gardens	OPEX*	✓ *feasibility study		✓ *installation		
<b>Principle 4: Enhance Cemetery Experience</b>								
4.1 - MR	Create Cemetery Business Plan	Ranger Services, Governance	OPEX	✓				
4.3 - MR	Installation of toilet (short-term portable toilet)	Asset Services, Works	OPEX* / CAPEX	✓ *portable toilet				
4.5 - MR	Vegetation screening along existing 1.2m high fence along northern boundary.	Works	OPEX		✓			

OPEX\* - operational expenditure included in budget

CAPEX\* - capital expenditure included in Long Term Financial Plan as adopted by Council



**Table 2 – Individual Projects – Karridale**

No	Project	Service Area	Funding resource	2023-24	2024-25	2025-26	2026-27	2027+
<b>Principle 1: Increase lifespan of the Cemeteries</b>								
1.1 - K	Investigate options for increasing lifespan	Legal / Governance	OPEX					✓
<b>Principle 2: Conserving Heritage Values</b>								
2.1 - K	Establish a 'friends of' group	Environmental/ Landcare	OPEX*	✓				
2.2 - K	Launch an interactive geographic information system with search functionality on the Shire website	ICT, Asset Services	OPEX*				✓	
<b>Principle 3: Improve Access within Cemetery</b>								
3.1 - K	New historical entrance map	Asset Services, Works	CAPEX				✓	
3.2 - K	Installation of signage for denominational areas	Asset Services, Works	CAPEX*		✓			
3.3 - K	Install internal walkways	Parks and Gardens	OPEX	✓ *feasibility study		✓ *installation		
<b>Principle 4: Enhance Cemetery Experience</b>								
4.1 - K	Create Cemetery Business Plan	Ranger Services, Governance	OPEX	✓				
4.2 - K	Installation of seating in priority locations	Asset Services, Works	CAPEX*	✓			✓	
4.3 - K	Installation of toilet (short-term portable toilet)	Asset Services, Works	OPEX* / CAPEX	✓ *portable toilet				
4.4 - K	Shelter - Design phase	Contractor	CAPEX				✓	
4.5 - K	Operational maintenance priorities	Works	OPEX*	✓				

OPEX\* - operational expenditure included in budget

CAPEX\* - capital expenditure included in Long Term Financial Plan as adopted by Council

All future capital and/or operational works projects are to be in accordance with the Cemetery Style Guidelines as detailed in Appendix 1.



# Summary

The Cemeteries 50-Year Masterplan provides a roadmap for the future development and management of the Margaret River and Karridale cemeteries. By implementing the recommendations outlined, the Shire will enhance services, improve infrastructure, and create a sustainable and inclusive environment for visitors. The Masterplan aligns with the community's needs, honours the memories of the departed and ensures the cemeteries long-term viability and relevance.

This Masterplan is to be reviewed every two years to ensure that the plan remains relevant, adaptable and aligned with the evolving dynamics of the community, industry standards and regulatory requirements. It supports the long-term success and sustainability of the cemetery as a cherished place of remembrance and community service.



# Appendices

## Cemetery Style Guidelines

These style guidelines are to be used for the design and aesthetics of the Margaret River and Karridale cemeteries.

### Materials

All materials be limited to local indigenous vegetation and material which will blend into or deteriorate into surroundings.

### Pathways and walkways

- Design well-maintained and accessible pathways that provide safe and convenient access throughout the cemetery.
- Use materials that are durable, non-slip, and visually appealing, such as stone, concrete, or pavers.
- Consider different pathway widths to accommodate pedestrians, wheelchair users and visitors with strollers.

### Signage and wayfinding

- Use clear and easily readable fonts, symbols, and colours for signage, ensuring they are legible under different lighting conditions.
- Incorporate bilingual or multilingual signage if necessary to accommodate diverse linguistic backgrounds within the community.

### Structures and facilities

- Ensure that these structures complement the overall cemetery design, using materials and architectural styles that harmonise with the surrounding landscape.
- Incorporate accessible features, such as ramps, handrails, and appropriate signage, to ensure equal access for all visitors.

### Plant species for natural burial area:

Scientific name	Common name
<i>Agonis flexuosa</i>	Peppermint tree
<i>Melaleuca lanceolata</i>	Moonah
<i>Melaleuca huegelii</i>	Honey myrtle
<i>Mirbelia dilatata</i>	Holy leaved Mirbelia
<i>Dodonaea aptera</i>	Coastal Hop-bush
<i>Diplolaena dampieri</i>	Southern Diplolaena
<i>Hibbertia furfuracea</i>	
<i>Templetonia retusa</i>	Cockies tounge
<i>Spyridium globulosum</i>	Basket bush
<i>Conostylis aculeata</i>	Prickly Conostylis
<i>Lepidosperma gladiatum</i>	Sword sedge
<i>Acrotriche cordata</i>	Coast Ground berry

### Environmental considerations

Preserve and protect existing trees and natural features, integrating them into the Margaret River and Karridale cemeteries design whenever possible.





# MARGARET RIVER CEMETERY

LANDSCAPE MASTERPLAN  
MARGARET RIVER, WA (RESERVE 12298)





# 1.0 EXISTING SITE ANALYSIS



The Margaret River Cemetery is located on Reserve 12298 on the south side of Wallcliffe Road and west of Caves Road. It covers a total area of approximately 46,300 square metres and is located on the major travel route between the Margaret River town site 7km to the east and the beach side suburbs of Prevelly and Gnarabup 3km to the west along Wallcliffe Road. The Cemetery has been slowly developed over a long period of time allowing an informal layout to occur with large native trees retained throughout. Combined with gravel roads and pathways, minimal signage and simple walls and feature elements, the overall aesthetic of the Cemetery provides a local and rural feel.

The Wallcliffe Fire Brigade Facility shares a common carparking area on the western side of the Cemetery and the Margaret River Golf Course abuts the southern boundary although is partially screened by a band of existing vegetation contained within the project site.

The eastern boundary is shared with an existing private residence that again is screened by a dense band of existing native vegetation. It is suggested that this band of vegetation contains possible unmarked grave sites and is not suitable for further development. The adjacent property on the north side of the Cemetery is also private property currently retained as a rural grazing paddock and used for overflow carparking during major local events such as the Margaret River Pro surfing competition.

The site grades from a high of RL 58.2 metres above sea level in the north-west corner down to approximately RL 53.8m in the north-east corner over a distance of approximately 135m. Large areas of retained native vegetation occur on the southern and eastern boundaries screening views to adjacent property. Stands of trees within the site and along Wallcliffe Road provide shade and some shelter.

An existing red asphalt dual use pathway is located within the southern verge of Wallcliffe Road that directly abuts the Cemetery boundary in a number of locations. Similar to Wallcliffe Rd itself, this is a major pedestrian and cyclist travel route linking Margaret River town to the beach that provides key views into the Cemetery and the Cemetery therefore has a major impact on a high volume of locals and visitors utilising this travel route.

An existing 1.2m high galvanised post and rail fence with galvanised chain wire mesh occurs along this northern boundary and weaves around large existing WA Peppermint trees. Similar fencing to the western boundary has been removed as part of recent revegetation planting works to the north-west corner of the project site in-keeping with the Shires Wallcliffe Rd landscape treatments in town.

Power & water are the only services provided to the site. Currently the water is disconnected or not used although it was recently commissioned for temporary irrigation of the recent revegetation works.

## LEGEND

- EXISTING MEMORIAL WALL OR STRUCTURE
- EXISTING MAIN ENTRY POINTS, VEHICULAR & PEDESTRIAN ACCESS
- EXISTING BENCH SEAT

- KEY VIEW OR VISTA
- EXISTING SERVICE LOCATION
- EXISTING SIGNAGE LOCATIONS

- EXISTING POST & RAIL MESH FENCE
- EXTENT OF PROJECT SITE

- LOT BOUNDARY (WHITE LINE)
- EXISTING CONTOURS (0.2m INTERVALS)
- EXISTING ROAD OR CARPARK AREA

- EXISTING GRAVEL ROAD OR PATH
- BURIAL SITES NON-DENOMINATIONAL
- BURIAL SITE ROMAN CATHOLIC

- BURIAL SITES ANGLICAN
- BURIAL SITES CONGREGATIONAL
- EXISTING SURVEYED TREE LOCATION

- EXISTING TREE CANOPY COVER
- EXISTING PLANTED GARDEN AREA
- EXISTING SURVEYED EDGE OF VEGETATION



## MARGARET RIVER CEMETERY LANDSCAPE MASTERPLAN DRAFT CONCEPT PLAN

DWG: AMR-03  
DATE: 24.02.2017

© THE DRAWINGS CAN NOT BE PUBLISHED OR USED WITHOUT THE INFORMATION PURPOSE ONLY AND MAY ALTER WITHOUT NOTIFICATION.





## 2.0 EXISTING SITE FEATURES

**2.1 EXISTING VIEWS AND VISTAS**  
The existing frontage onto Wallcliffe Road is very basic with gravel verge, asphalt path & galvanised fencing the majority of the interface & allowing views over the cemetery. Large retained trees contribute the highest visual impact. Both entry points on the west & north provide a key vista down the gravel roads to the existing shelter & niche walls. This is the current focal point within the Cemetery allowing views back out these entry roads & paths as well. Internally there are broad views across the entire Cemetery due to the gradual slope across the site & only intermittent retained clumps of trees.

**2.2 EXISTING STRUCTURES & FURNITURE**  
The main entry statement to the Cemetery is access gates off the existing carpark & Wallcliffe Rd. Both are powdercoated black with minor finestrations creating a very low key entry & sense of arrival. Two rendered brick memorial niche walls exist in the centre of the Cemetery & contain a mosaic tile feature pattern. The main niche wall is covered by a basic curved steel frame and colourbond roof. There are several existing bench seats within the site constructed of recycled plastic & grey in colour. Overall the structures & furniture have minimal visual impact continuing the low key rural aesthetic & focus on minimising maintenance.

**2.3 EXISTING SIGNAGE & FENCING**  
Signage for the Cemetery only occurs with a simple timber sign at the entry to the carpark. Traffic signs & bushfire warning signs dominate along the Wallcliffe Rd frontage along with exposed service conduits that detract from the visual appeal of the Cemetery. Similarly, the existing galvanised fence is worn & damaged further detracting from the appearance of the Cemetery. Access gates provide the main focal point to the entry of the Cemetery with no internal signage or directional signage currently provided.

**2.4 EXISTING MATERIALS & FINISHES**  
Much like the structures & furniture within the Cemetery, the material palette is very simple & low key. The carpark is black asphalt, dual use pathway red asphalt & main roads & access paths through into the Cemetery loose road base or gravel. Some woodchip mulch has been spread through the burial areas however the majority of the internal site is bare earth or dry grass containing large amounts of weed. The represents a previous focus to minimise maintenance requirements of the Cemetery. Loose gravel pathways within the site do pose some safety & access concerns for universal access through the site.

**2.5 EXISTING VEGETATION & LANDSCAPING**  
The key feature & visual impact on the existing Cemetery is the retained mature native vegetation. Surrounding the southern & eastern boundary & with large trees or clumps throughout the site and along Wallcliffe Rd verge, the native vegetation attributes a very local & low key bushland feel to the site. Trees either side of the main entry road off Wallcliffe create an informal avenue framing views to the existing niche wall & shelter. The trees provide essential shade & shelter within the site which is quite open & exposed to wind & hot sun.





# 3.0 LANDSCAPE MASTERPLAN

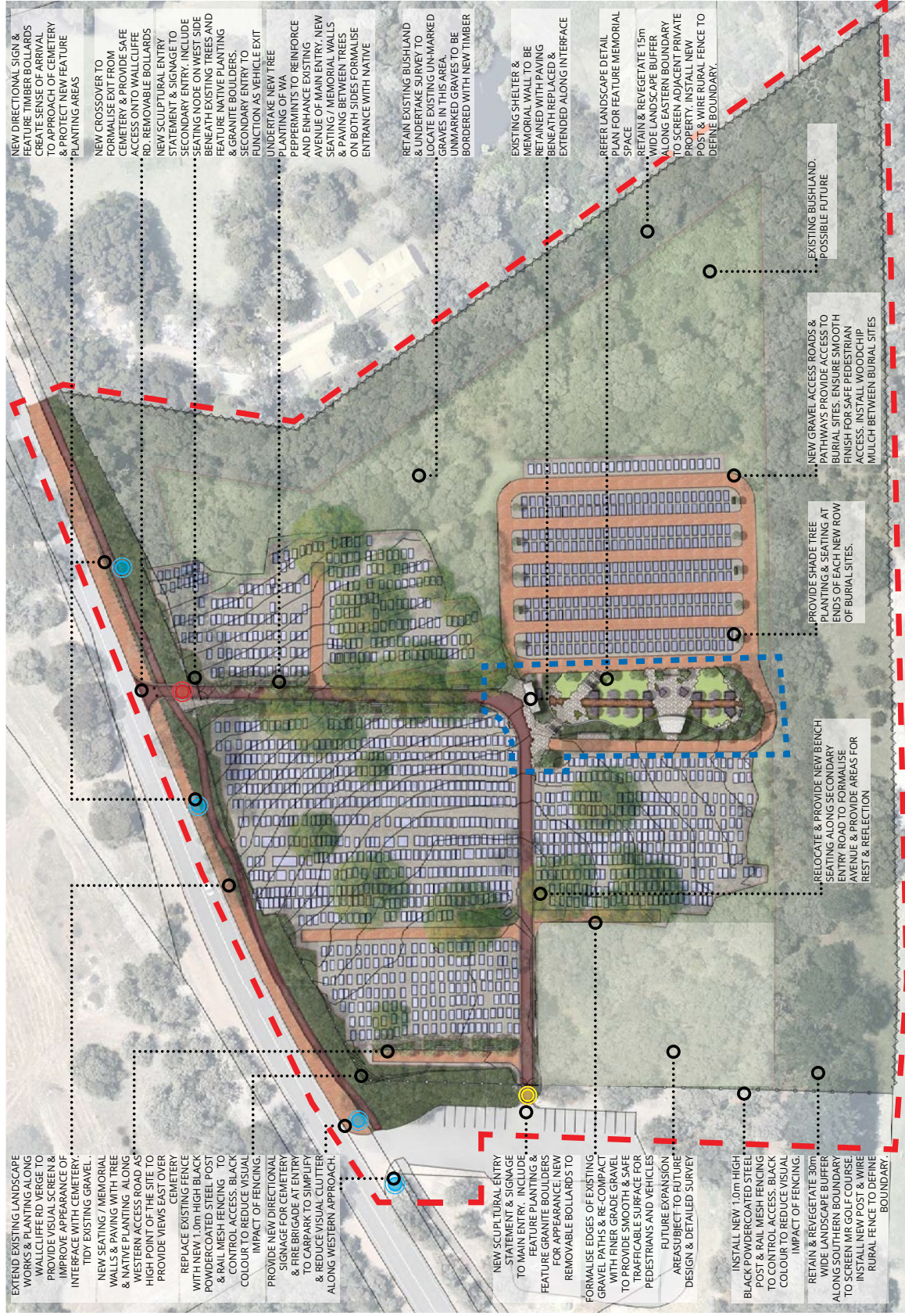

This Landscape Masterplan for the Margaret River Cemetery proposes to build upon existing site features & natural elements to improve the overall visual aesthetic of the site while providing greater physical amenity, better & safer access without significantly increasing the on-going maintenance costs or attendance requirements. This includes the development of a feature memorial space extending south from the centre of the Cemetery to provide a more formalised multi-functional space suitable for gatherings and ceremonies but also to provide a series of quiet places and secluded areas for contemplation and reflection.

Key to improving the overall visual appearance of the Cemetery is to improve the visual amenity along Wallcliffe Road. New sculptural entry statements & replacement of the existing degraded fencing will signify a change of land use & draw attention to the Cemetery from vehicles and pedestrians passing by. Bollards are proposed either side of the entry to control parking & access while allowing a continuation of the native flowering gardens along the full length of the Wallcliffe Rd interface. Signage along Wallcliffe Rd should also be amalgamated & simplified where possible to minimise any visual clutter that detracts from the appearance of the Cemetery.

To improve access through the site for both vehicles & pedestrians it is proposed the main internal road linking the main and secondary entry points be constructed from red asphalt or fine gravel & edged with flush concrete kerb. This reinforces the key view corridors through to the feature memorial space. All other existing gravel roads & paths should be re-compacted with a finer grade material & edged to provide a smoother even surface suitable for universal access. Existing surface material between burial sites should be maintained to ensure reduced weed growth to provide an even surface finish for better access & appearance.

Native garden beds and new shade tree planting are proposed either side of the main internal access road again to reinforce key views through to the feature memorial space and provide colour and shade through the Cemetery. This also provides some separation & screening or division of the different burial denomination areas. Feature low seating walls established along the main entry provide amenity & more formal resting & reflection spaces. Relocation of existing bench seating & addition of further bench seats also provide informal seating & resting spaces across the site.

- LEGEND**
- NEW MAIN ENTRY WITH SCULPTURAL ENTRY STATEMENT & SIGNAGE
  - NEW SECONDARY ENTRY STATEMENT GATES & SIGNAGE
  - NEW DIRECTIONAL SIGNAGE LOCATIONS
  - EXTENT OF WORKS

			</	







# 5.0 LANDSCAPE MATERIALS PALETTE

## 5.1 SHELTERS & STRUCTURES

Shelters & structures are proposed within the Cemetery to provide shade & shelter for both groups & individuals. They will be the main vertical elements within the Cemetery creating a key feature or focal point. They should therefore be sculptural or unique in form. Any structures should be constructed of hard wearing, long lasting materials such as concrete or steel as a base. Feature components & signage can then be added from local materials such as timber, stone or weathered steel to reinforce the rural, informal & low key aesthetic of the Cemetery.

## 5.2 SCULPTURES, ARTWORK & ARBOURS

These elements are proposed at the main entry points to the site & internally at the feature memorial space. These will also form a focal point along vistas & key axis within the Cemetery. It is intended that any sculptural feature is also multi-functional to provide seating, create a gateway or provide shelter from the sun or wind. Similar to the shelters, they should be constructed of hardwearing local materials such as steel, concrete, limestone, granite stone, hardwood timber or weathered steel to minimise maintenance. Simple forms & shapes with feature elements or colours should be used to reinforce the rural & natural feel of the site.

## 5.3 SIGNAGE & FURNITURE

Signage within the Cemetery should be clear in function as either directional or entry statement signage. Any signage should form part of a sculptural or artwork element or be simple in form & construction. Furniture also can be built into sculptural & artwork elements or built into walls & shelter to provide informal opportunities for rest, contemplation & reflection. Timber, limestone, granite stone & weathered steel are preferred materials to provide hard wearing finishes that are still soft in appearance or to touch for the purpose of seating & resting.

## 5.4 HARDSCAPE MATERIALS

Hardscape materials proposed aim to create a hierarchy of pathways & spaces within the development. They also much provide for safe & easy access through out the site. Asphalt roads provide main access for vehicles & pedestrians which then changes to crushed compacted laterite gravel or road base for minor roads & internal paths. Mulch or sawdust is then proposed as a low maintenance finish amongst the burial sites. A combination of feature paving & exposed aggregate concrete, in local South West colour tones, at the feature memorial site enhance appearance at

## 5.5 SOFTSCAPE MATERIALS

Planting throughout the site is proposed to enhance & build upon the existing natural features & bushland appearance. Additional native tree planting to the entry roads provide further shade & reinforce avenues for key views. To highlight the feature memorial space deciduous colourful & textural trees such as Jacaranda & Silver Birch are proposed along the central space to provide dappled light over the turf & informal seating areas. All shrub & groundcover planting should match the existing verge plantings with species to match the Shires Wallcliffe Upgrade Works.





# 6.0 SHELTER CONCEPT SKETCH

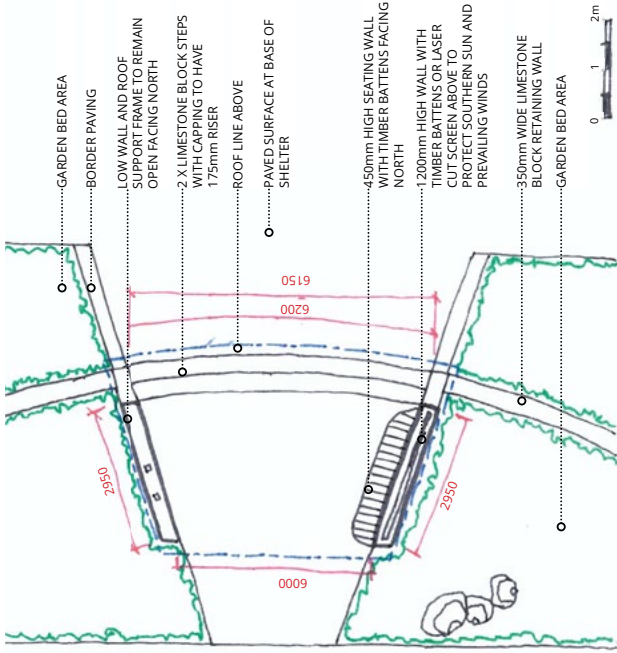

6.2 SHELTER - Plan View with Roof Removed

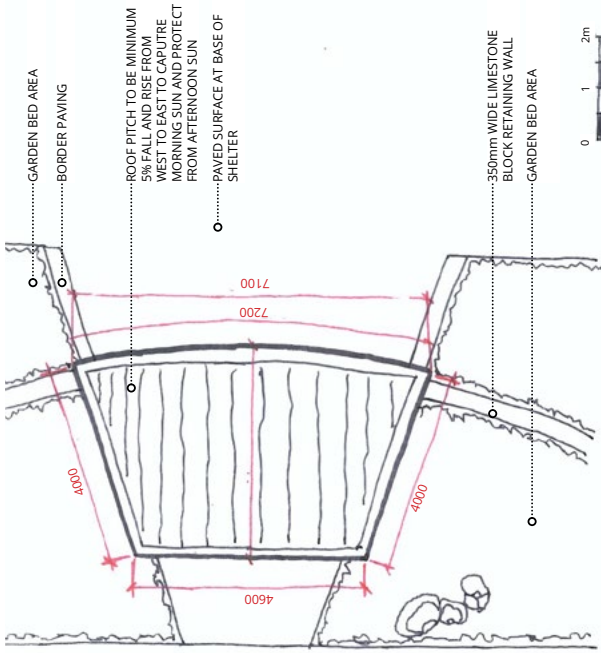

6.1 SHELTER - Plan View of Roof Structure

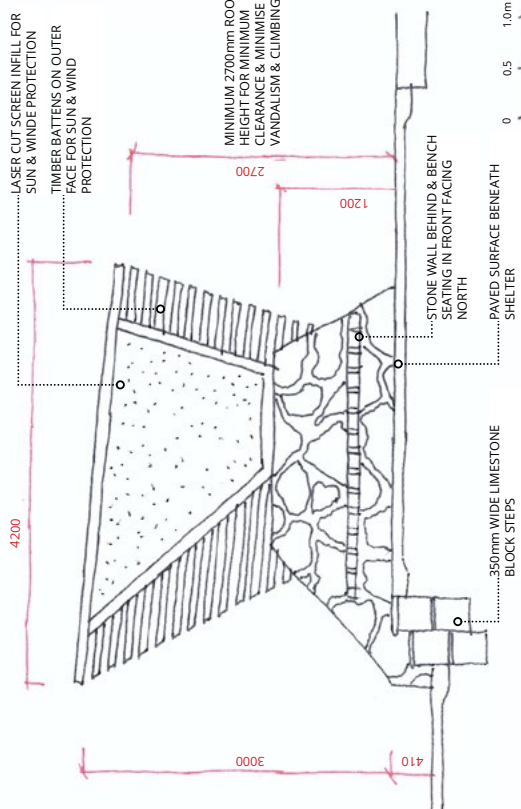

6.4 SHELTER - Section View looking South

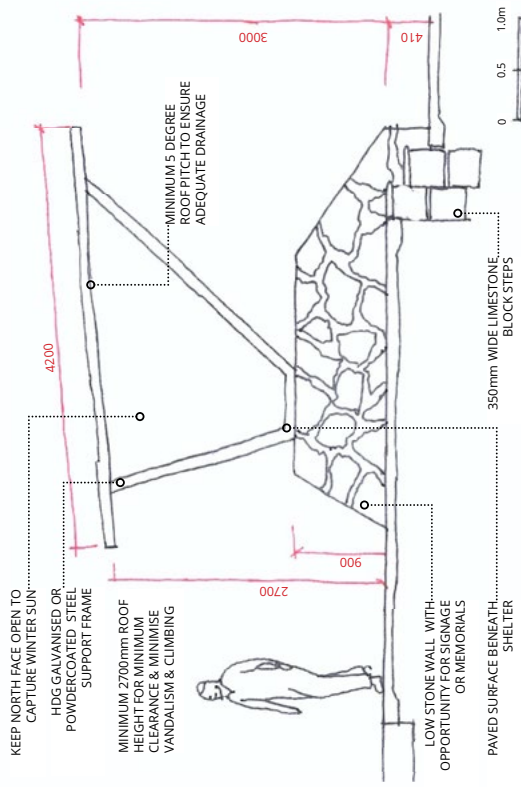

6.3 SHELTER - Section View looking North



### 3. Karridale Cemetery Landscape Concept







Artist impression looking north towards proposed shelter and gathering space. Seating is provided under the shelters with additional informal seating provided by the gabion walls. Existing vegetation is retained where feasible, tidied and additional planting added. The shelters opens up onto the lawn area creating further room for larger groups to gather at a funeral.



Park bench with back rest



Shelter



Gabion walls with timber slatted top

## Legend

1. Existing entrance gate
2. Existing vehicular access
3. Exposed aggregate path
- 4a. Existing niche walls
- 4b. Future niche wall when current structure reaches capacity.
5. Two identical proposed shelters providing a space to gather.
6. Bench seat spanning the length of the shelter
7. Gabion walls filled with local granite & slatted Jarrah tops to provide informal seating
8. Garden bed with native mass planting
9. Retaining wall with stair access to surrounding open space
10. Park benches with back and arm rests providing a space to rest and reflect
11. Existing trees to be retained and crown lifted
12. Existing vegetation to be thinned out to improve visibility into the cemetery. Additional infill planting of low growing colourful natives enhancing the aesthetic.
13. Fencing to be upgraded to black ring lock fencing with additional ironstone pillars
14. Proposed additional pedestrian entry gate with ironstone pillars to either side

NOTE: Existing shelter to be removed due to aging and redundancy once new shelters are installed and to make room for the future expansion of the niche walls. The existing water tank will need to be removed to allow for the placement of the new shelters and optimising the layout of the space.

## Karridale Cemetery LANDSCAPE PLAN

Date: May 2022  
 Drawing: KCCP\_01A  
 Revision: DRAFT  
 Scale: 1:100@A1







amrshire@amrshire.wa.gov.au

[amrshire.wa.gov.au](http://amrshire.wa.gov.au)

---

If you are deaf, or have a hearing impairment or speech impairment, contact us through the National Relay Service:

- TTY users phone 133 677 then ask for 08 9780 5255
  - Speak and Listen users phone 1300 555 727 then ask for 08 9780 5255
  - Internet relay users connect to the NRS [www.relayservice.com.au](http://www.relayservice.com.au) then ask for 08 9780 5255
- 

### **Margaret River**

41 Wallcliffe Rd (PO Box 61)  
Margaret River WA, 6285

**T** 08 9780 5255

**F** 08 9757 2512

#### **Office Hours**

Mon to Fri, 9am – 4pm

#### **Phone enquiries**

8.30am – 4.30pm

### **Augusta**

66 Allnut Tce, Augusta WA, 6290

**T** 08 9780 5255

**F** 08 9757 2512

#### **Office Hours**

Tue to Thu 9am – 12pm, 1pm – 4pm

#### **Phone enquiries**

8.30am – 4.30pm